

SITE KEYNOTES	
1.	(E) PARKING
2.	NEW ACCESSIBLE PARKING
3.	NEW ADA PARKING SIGNAGE
4.	(E) SIDEWALK
5.	NEW SIDEWALK TO ALIGN WITH EXISTING
6.	(E) CURB
7.	NEW CURB TO ALIGN WITH EXISTING
8.	(E) RELOCATED BENCH
9.	(N) RELOCATED LIGHT POLE: TO BE COORDINATED WITH ELECTRICAL ENGINEER
10.	NOT USED
11.	(E) DUMPSTER ENCLOSURE TO BE RELOCATED
12.	(E) BERM TO TERMINATE AT THIS LOCATION
13.	(E) BERM TO REMAIN

GENERAL NOTES	
1.	CONTRACTOR SHALL VERIFY ALL EXISTING CONDITIONS AT SITE & SHALL NOTIFY ARCHITECT OF ANY DISCREPANCIES PRIOR TO BIDDING.
2.	CONTRACTOR IS RESPONSIBLE FOR, AND SHALL VERIFY, ALL EXISTING WATER, POWER, SEWER, & ELECTRICAL UTILITY CONDITIONS - INCLUDING ALL SUB-TERRANEAN CONDITIONS, AND IS RESPONSIBLE FOR MAKING ALL CODE COMPLIANT CONNECTIONS TO EACH AS REQUIRED.
3.	ALL LANDSCAPE SHOWN IS EXISTING AND SHALL REMAIN. REFER TO CIVIL FOR INFORMATION REGARDING ALL EXISTING AND NEW CONTOURS, ELEVATIONS, AND UTILITIES.
4.	ELECTRICAL SUBCONTRACTOR SHALL FURNISH AND INSTALL SITE LIGHTING AS REQUIRED BY THE CITY OF OKLAHOMA CITY AND ANY APPLICABLE CODES/ORDINANCES. SITE LIGHTING SHALL BE COORDINATED WITH ARCH/OWNER PRIOR TO INSTALLATION.
5.	CONTRACTOR TO INCLUDE ALLOWANCE FOR NEW PLANTINGS AT MEDICAL ENTRANCE AND PICNIC BENCHES.

  

PARKING CALCULATIONS	
<b>MEDICAL SERVICES:</b>	
PER TABLE 10600.2 - OKC PARKING ORDINANCE	
1 SPACE/ 200 SQ. FT. - FOR THE FIRST 12,000 SQ. FT.	
1 SPACE/ 225 SQ. FT. - FOR 12,001 TO 48,000 SQ. FT.	
12,000 SQ. FT. / 200 SQ. FT. = 60 SPACES	
31,743 SQ. FT. / 225 SQ. FT. = 141 SPACES	
TOTAL PARKING SPACES REQUIRED:	201 SPACES
TOTAL PARKING SPACES PROVIDED:	203 SPACES
<b>ACCESSIBLE PARKING SPACES:</b>	
PER OKC PARKING ORDINANCE	
FOR 200+ SPACES: 7 ACCESSIBLE SPACES REQUIRED	
TOTAL SPACES PROVIDED: 15	

Project:  
**Variety Care Straka Terrace  
 Renovation and Remodel**  
 1025 Straka Terrace  
 Oklahoma City, OK 73139

**HORNBECK • BLATT**  
 architects

101 South Broadway Suite 200  
 Edmond, Oklahoma 73034  
 405.340.8552 Telephone  
 405.340.5707 facsimile  
 www.hornbeckblatt.com

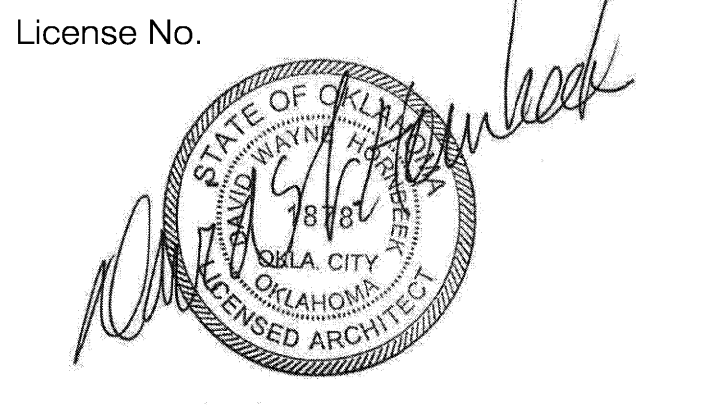
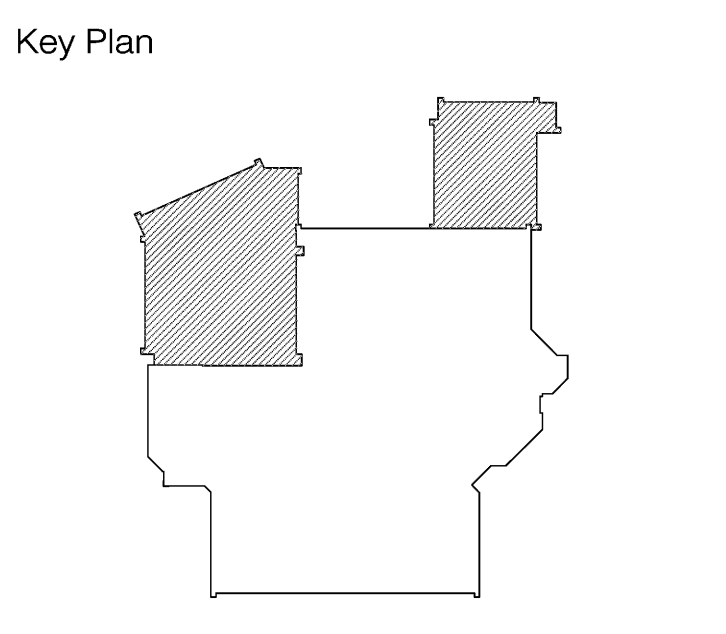

Designed By:  
 Drawn By:  
 Reviewed By:

No.	Date:	Submission:
	07/15/13	ISSUE FOR PERMIT
	08/30/13	ISSUE FOR BID

These documents & images are the sole property of Hornbeck Blatt Architects & are not to be reproduced or copied, either wholly or in part in any form without written permission from Hornbeck Blatt Architects.  
 Copyright 2006 © Hornbeck Blatt Architects

Drawing Title:  
**Architectural  
 Site Plan**

Sheet No: